

# Swivel castor with wheel brake 531 PT 50 P

Furniture Castors Series 530 PL - Wheel P

-20 °C - +60 °C

+++  
swivels easily

+++  
wear resistant

+++  
shock proof

+++  
floor protective

+++  
weather proof

## Wheel

Casted high quality nylon wheel black

High quality nylon housing - black

Swivel bearing with combined  
plain-ball bearing

Wheel brake - glass fibre reinforced

Wheel axle revited

Swivel castor with wheel brake Wheel-Ø A x width B mm: 52x8+8

Load Capacity kg: 40

Load capacity tested according to EN 12530 and EN 12527

Overall height H mm: 63

Dimension of top plate TP 39x39  
mm:

Hole spacing HS mm: 30x30/24x24

Hole-Ø HD mm: 5,2

Swivel radius SR mm: 69

Wheel bearing: Nylon plain bearing

## Advantages

- ✓ easy running on smooth floors
- ✓ impact proof
- ✓ high abrasion resistance
- ✓ easy to clean
- ✓ high chemical resistance

©Copyright 2024 Rollenbau GmbH, www.rollenbau.at 21.05.2024

ROLLENBAU

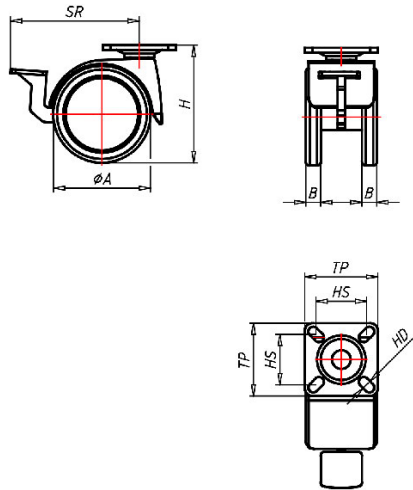

## Applications

- Book carts
- Sidetables
- Laboratory equipment
- Instrument stands
- School furniture
- Bedside carts
- Health-Professionals